

Tile it

HOW TO APPLY QUADROSTYLE TILE STICKERS



SUITABLE SURFACES

Smooth ceramic wall and floor tiles
Drywall painted in a satin or gloss paint
Laminated surfaces (e.g. Formica, melamine, IKEA furniture)
Linoleum, vinyl, and laminate flooring
Parquet and varnished wood
Sealed concrete
Sealed polished stone (e.g. granite, marble, terrazzo)
Glass, Metal, Plastic, Acrylic, Perspex

SURFACES TO AVOID

Rough or textured wall and floor tiles
Irregular edged tiles or pocked surfaces (e.g. handmade tiles, tumbled marble)
Drywall painted in a matte, velour, or chalk finish
Cracked paint, old wallpaper
Unsealed subflooring, unsealed plywood, or raw wood
Waxed or oiled wood panelling
Unsealed concrete or stone tiles
Ceramic tiles with a wax coating
Cork or any other porous surface
Damp or cracked surfaces
Brick or slate

You will need

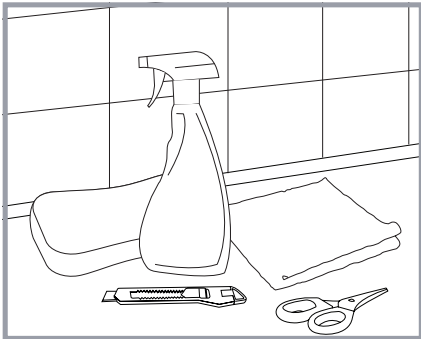

A general purpose kitchen cleaner & sponge.
A utility knife and a pair of scissors.
A soft cloth.

Step 1

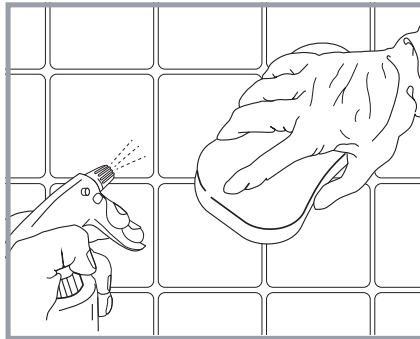

Clean the tiles thoroughly to remove any grease or dirt, then leave to dry.

Step 2

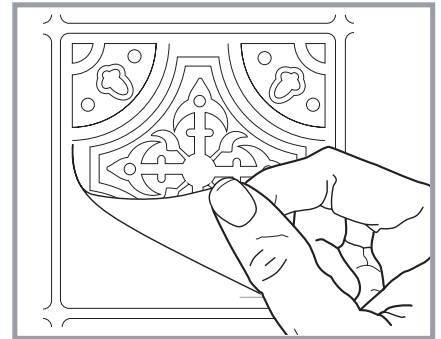

Peel away the backing paper and position the sticker directly over the tile.

Note: the sticker needs to fit neatly over the tile and must not overlap onto the grout line.

Step 3

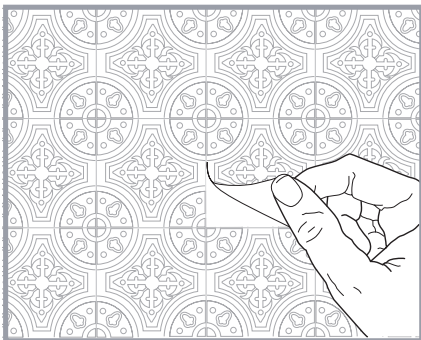

Using a dry cloth, smooth the sticker into position, pushing any bubbles out to the edges. Ensure all 4 sides are stuck down firmly.



Important !

The sticker must not overlap the grout line.
Not suitable for tiles with curved edges.



The stickers can be wiped clean with a damp cloth and general, non-abrasive household cleaners. Avoid scrubbing and harsh chemicals. Wipe away splashes which may stain (eg curry or tomato) immediately.